



AR 500- Triple Threat

Assembly Steps:

1. Layout all items onto work bench
2. Insert the 3 Legs into the Base, as Shown in Fig. 1
3. Insert quick pins into the two outside holes on mounting base to secure feet, see Fig. 1
4. Slide Silhouette Main Support into the center of the base, as shown in Fig. 2 ****Note...Main support can be placed in forward slot, middle slot, or back slot, this allows for angle adjustment of the target.**
5. Insert quick pin into the center hole on mounting base to secure main support, see Fig. 2
6. Mount all Brackets to silhouette with carriage bolts & Nuts, as shown in Fig. 3
5. Set the base on the ground, and slide silhouette onto main support, secure with short quick pin, see Fig. 4
6. Slide all paddles into mounting brackets as shown in Fig. 5

Part Number

TRPLT-001

Tools Required

- 19mm Wrench



FIG 1.

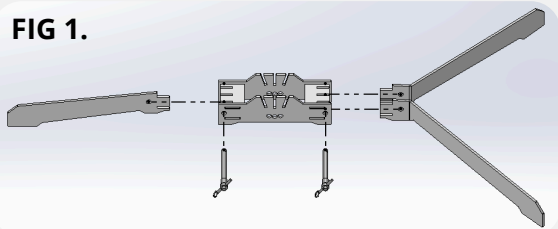

FIG 3.

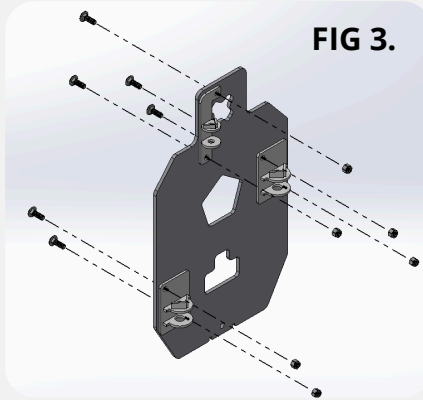

FIG 4.

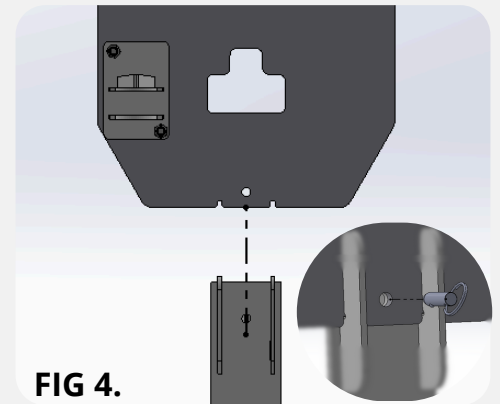

FIG 2.

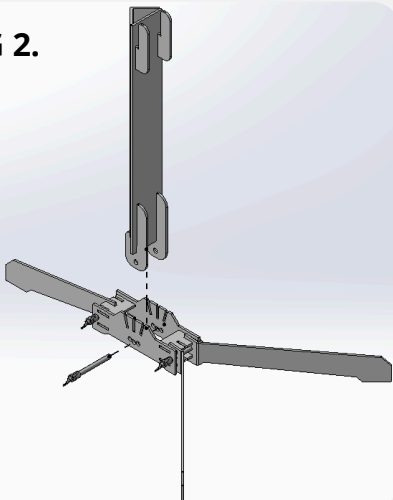

FIG 5.

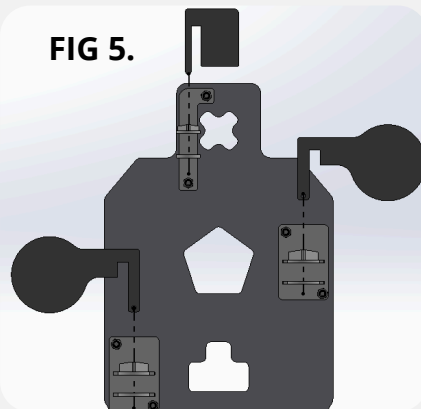

FIG 6.

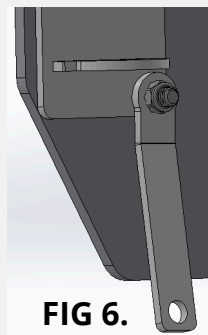
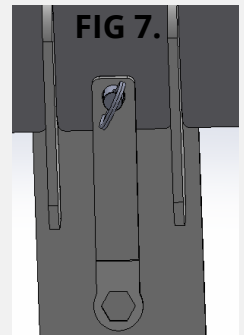

FIG 7.



Notes:

See Fig. 6 for how to use included wrench

See Fig. 7 for convenient wrench storage

